



Xbox Series X Back Panel Replacement

Prerequisite-only guide! This guide is part of...

Written By: Carsten Frauenheim



INTRODUCTION

Prerequisite-only guide! This guide is part of another procedure and is not meant to be used alone.

Use this guide to remove the back panel on an Xbox Series X.

TOOLS:

TR8 Torx Security Screwdriver (1)

Spudger (1)

ESD Safe Blunt Nose Tweezers (1)

Tweezers (1)

Step 1 — Uncover the back panel screws

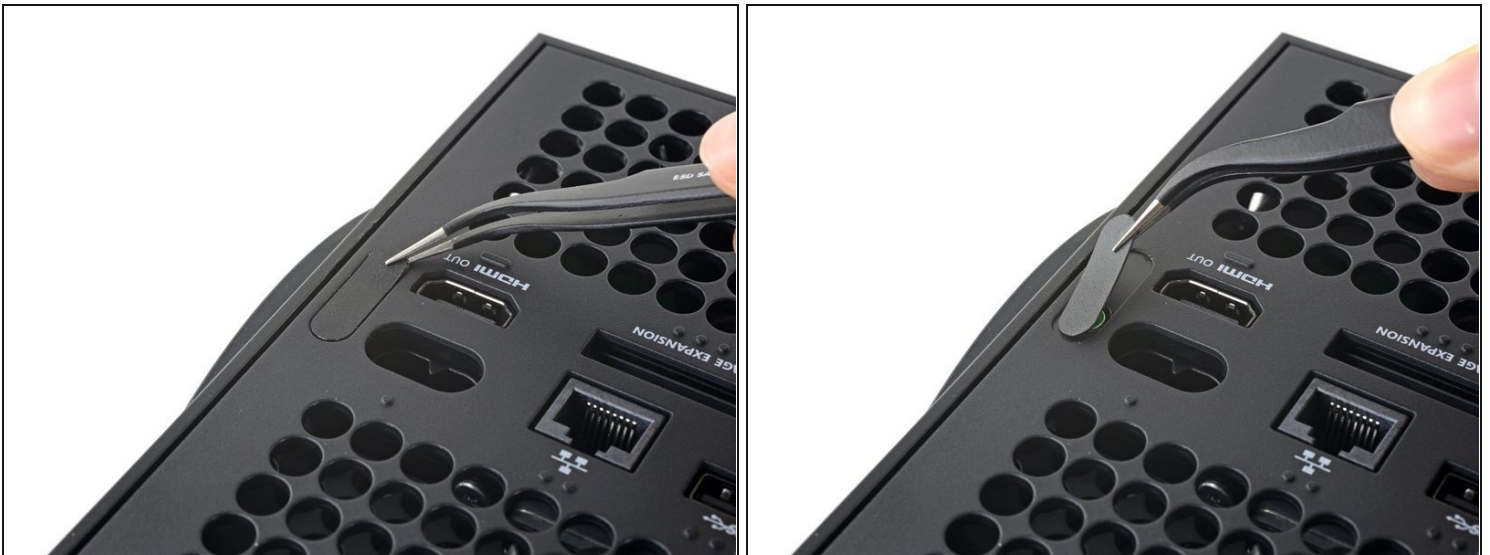

 Before you begin, completely power down and unplug all cables from your console.

- Use a pair of tweezers to remove the sticker hiding the first screw on the back panel, near the base.

Step 2



- Use a pair of blunt tweezers to peel back the large sticker on the back panel to reveal the second screw.
- ① You only need to peel this sticker to where you can access the hidden screw. You don't need to pull it completely off.
- ① Technically, these are tamper-evident stickers, but don't worry—[Microsoft can't legally void your warranty](#), as long as you don't damage anything. Have fun!

Step 3 — Remove the back panel screws



- Use a T8 Torx driver to remove the two 7.4 mm-long screws securing the back panel.
- ① Throughout this repair, [keep track of each screw](#) and make sure it goes back exactly where it came from to avoid damaging your console.

Step 4 — Unclip the back panel



- Insert the flat end of a spudger into the gap between the back panel and the shell, near the left side of the base.
- Pry up the back panel to release it from the locking clips.

Step 5



- Insert the flat end of a spudger into the gap between the back panel and the shell, near the right side of the base.
- Pry up the back panel to release it from the locking clips.

Step 6 — Remove the back panel



- Grip the back panel at the opening you just created and pull it up and away from the shell to unclip the long edges.

 During reassembly, press along the edges of the back panel to snap it into place.

Step 7



 The back panel slots into a gap at the top of the shell.

- Tilt the back panel up and pull it away from the top edge of the shell to release it from the gap.
- Remove the back panel.

To reassemble your device, follow these instructions in reverse order.