



# 1997-2003 Ford F-150 Power Side Mirror Replacement

This guide will allow you to replace the powered side view mirror of a Ford F-150, saving you precious time and money at a mechanic.

Written By: Carter Clark



## INTRODUCTION

It is not uncommon for a side view mirror to become detached with little impact. As such, knowing how to replace or reattach it at home can save you money. Beware any broken or protruding glass should the mirror you're dealing with be broken.



### TOOLS:

- [flat head philips screw driver](#) (1)
- [Phillips #0 Screwdriver](#) (1)
- [1/4" Nut Driver](#) (1)



### PARTS:

- [Aftermarket powered side view mirror](#) (1)

## Step 1 — Power Side Mirror



- Search for retaining screws holding the door handle bezel. If there aren't any, that's your clue that it snaps into place. There should be a small opening on the edge of the bezel.
- Place the tip of a flathead screwdriver into the gap and gently pry, it should begin to come off, at which point simply slide it off of the handle.

## Step 2

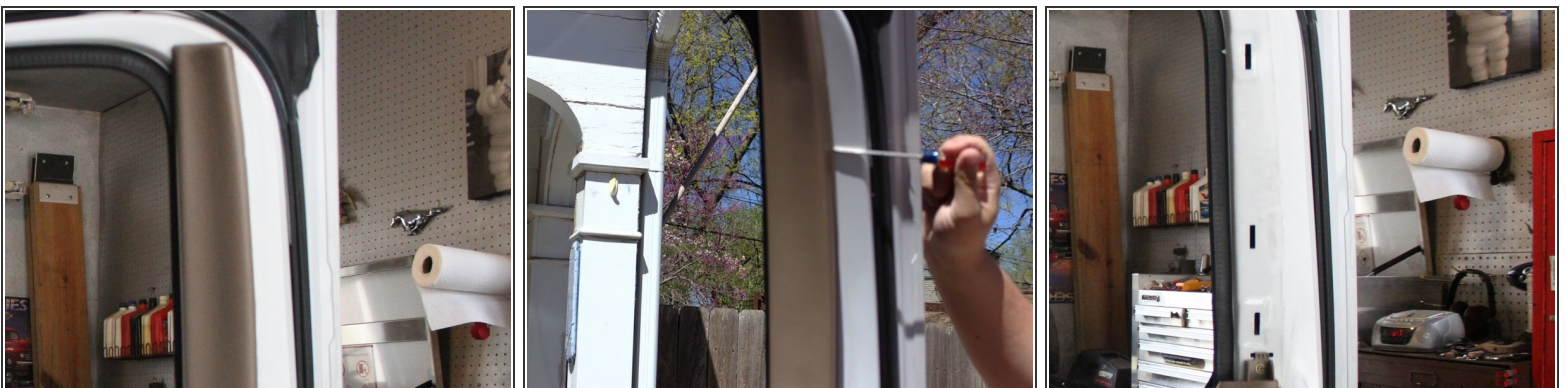

- There should be a small gap along the edge of the upper door trim. Place the tip of a flathead screwdriver in the gap and gently pry it off. There should be little resistance.
- When reassembling, it should simply snap back into place.



### Step 3



- ⓘ The window control panel may or may not have a small gap similar to the door bezel, this gap is merely for convenience. Should there be none: place the screwdriver on any edge and pry it underneath and then up and off.
- Remove the window control panel just beneath the handle, it should snap into place just like the door bezel. Disconnect the wired connectors.
- The connectors have a small pin that must be pushed in before they can detach, either use your fingers or a small Flathead screwdriver as shown in the pictures.
- Similar to the door bezel and trim panels, use a flathead screwdriver and gently pry the panel off.

## Step 4



- Remove the two screws behind the door bezel and the small segment above the door. Grip the door trim and pull upwards, it should come off with little resistance but do not completely remove it as there is one last step before it can be fully detached.

## Step 5



- Before completely removing the door trim be sure to remove the door light. Twist it 180 degrees and it should pop out without any excess pressure.



## Step 6



- Now you should see a black material covering the door. This is called a vapor panel and protects the innards of the door from water and moisture. It should peel right off, but don't be afraid to use the screwdriver to gain leverage.
- You will find another small connector similar to those found when disconnecting the window control panel. This operates the powered mirror and must be disconnected before the mirror is unscrewed.
- Remove the small triangular portion of the vapor plate where the mirror mounts, you should see 3 large holes, inside which are the mounting screws for the mirror.

## Step 7



- ⚠ Once the screws are removed the mirror will fall. Either have another person there to catch it, or have the window rolled down so that you can stick your arm through it and hold it yourself.
- Remove the three mounting screws, be sure the mirror does not fall, then line the new mirror up with the holes and reattach the screws.

To reassemble your device, follow these instructions in reverse order.