



# Lenovo ThinkPad T410s Battery Replacement

Before you start, make sure the replacement...

Written By: Jared Quintana



# INTRODUCTION

Before you start, make sure the replacement battery is compatible using this [guide](#). There are many ways to tell if the battery needs to be replaced. A few symptoms of a dead battery can be found [here](#).

## Step 1 — Battery

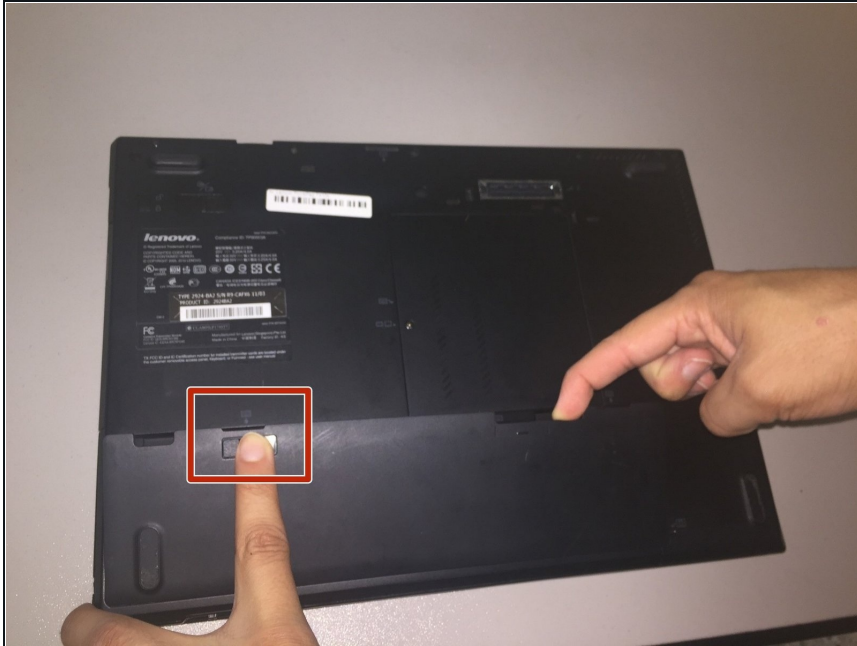

- Flip the laptop over.
- Push and hold the locking switch to the left.
- Pull the battery out with your other hand.

---

To reassemble your device, follow these instructions in reverse order.